

 Disney  
PRINCESS

 AGES  
3+

# Prettiest Princess Castle



CONTENTS: Castle, base, 3 princess door molds, tower presser, 3 princesses, and 4 two-ounce cans of PLAY-DOH Brand Modeling Compound (Net wt. 8 oz., 226 g).



## Assembly

**1**

Attach the castle to the base.

**2**

Attach the princess door molds. They're interchangeable.

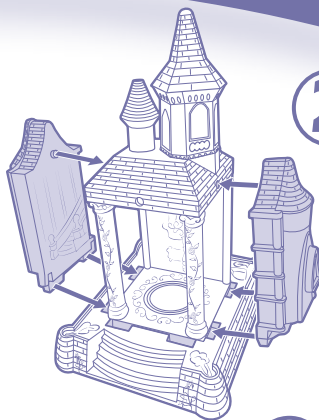
**3**

Attach the remaining princess door mold.

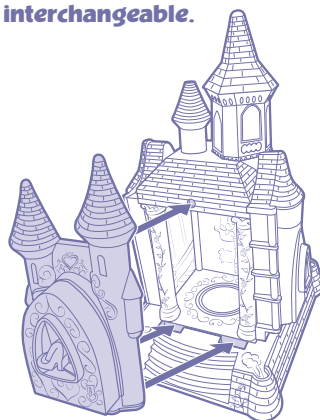

ADULT ASSEMBLY REQUIRED.

# Play-Doh

**NOTICE TO PARENTS: CONTAINS WHEAT.  
NONTOXIC. CONFORMS TO ASTM D-4236.**

**Each princess fits inside one of the book molds.**

**Fill each side of the princess mold with compound.**

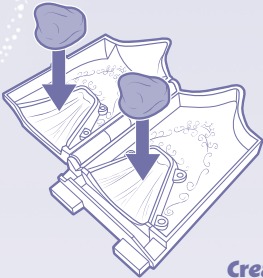

**Place the princess inside the mold and close.**

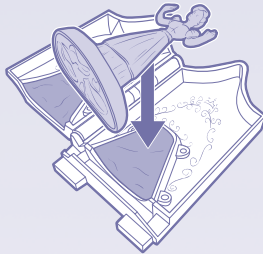

**Open the door to reveal your princess wearing a gown.**

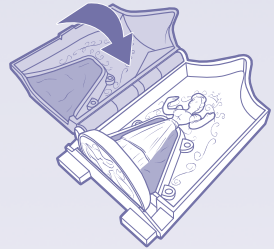

**Create accessories with the half-molds on the base of the castle and decorate the dress.**

## More fun features:

**• Fill the tower with compound and press out Rapunzel's hair.**



**• Shape stained glass.**

**• Create princess friends with the molds on the base of each figure.**

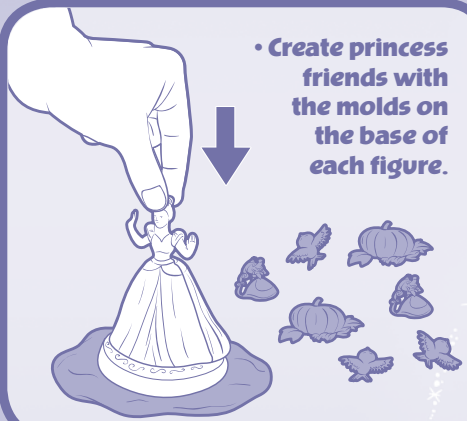

**Clean Up!**  
Remove excess compound.  
Allow the remaining compound to dry, then scrape or vacuum it away.

©Disney

®\* and/or TM\* & © 2012 Hasbro All Rights Reserved. TM & © denote U.S. Trademarks.

Product and colors may vary. Questions? Call: 1-800-327-8264

PLAY-DOH and the PLAY-DOH logo are trademarks identifying quality modeling compound products produced exclusively by Hasbro, Inc.

TM & © denote U.S. Trademarks.

U.S. Patent No. 6713624.

PN 7277400000



**Fun to play with, but not to eat.**